

AIR RATCHET WRENCH

AT-5353
1/2" Air impact ratchet wrench



AT-5351
1/2" Air impact ratchet wrench



AT-5159
1/2" Air ratchet wrench



AT-5057
1/2" Air ratchet wrench



AT-5253
1/2" Air ratchet wrench



AT-5053
1/2" Air ratchet wrench



AT-5054
1/2" Air ratchet wrench



Model No.	Square Drive	Capacity Bolt Size		Free Speed RPM	Max. Torque		Overall Length		Air Inlet (PT)	Air Hose (ID)	Avg. Air Consumption		Net Weight		Working Air Pressure		Packing Pcs/Ctn/G.W/Cuft (kg)	Sug. Air Comp. (HP)
		inch	mm		ft-lb	N.m.	inch	mm			scfm	l/min	lb	kg	psi	kg/cm ²		
AT-5053	1/2"	3/8	10	160	50	68	10.43	265	1/4"	3/8"	9.5	269	2.64	1.2	90	6.3	20/Ctn/27.0 kg /1.05'	2
AT-5054	1/2"	1/2	12	150	90	122	14.41	366	1/4"	3/8"	13	368	4.40	2.0	90	6.3	10/Ctn/21.3 kg /0.57'	3
AT-5057	1/2"	3/8	10	160	60	81	10.43	265	1/4"	3/8"	9.5	269	2.64	1.2	90	6.3	20/Ctn/27.0 kg /1.05'	2
AT-5159	1/2"	1/2	12	270	80	108	12.40	315	1/4"	3/8"	12	340	3.44	1.56	90	6.3	12/Ctn/20.5 kg /0.61'	3
AT-5253	1/2"	3/8	10	160	55	75	10.55	268	1/4"	3/8"	9	250	2.51	1.14	90	6.3	20/Ctn/25 kg /1.2'	2
AT-5351	1/2"	3/8	10	400	50	68	11.61	295	1/4"	3/8"	9	250	2.78	1.26	90	6.3	20/Ctn/29.0 kg /1.3'	2
AT-5353	1/2"	1/2	12	500	120	163	13.58	345	1/4"	3/8"	11	311	3.88	1.76	90	6.3	10/Ctn/24.3 kg /1.05'	3

3/8" AIR RATCHET WRENCH

AT-5352
3/8" Air impact ratchet wrench



AT-5350
3/8" Air impact ratchet wrench



AT-5153
3/8" Air ratchet wrench



AT-5158
3/8" Air ratchet wrench



AT-5252
3/8" Air ratchet wrench



AT-5056
3/8" Air ratchet wrench



AT-5251
3/8" Air ratchet wrench



AT-5257
3/8" Air ratchet wrench



AT-5052
3/8" Air ratchet wrench



Model No.	Square Drive	Capacity Bolt Size		Free Speed RPM	Max. Torque		Overall Length		Air Inlet (PT)	Air Hose (ID)	Avg. Air Consumption		Net Weight		Working Air Pressure		Packing Pcs/Ctn/G.W/Cuft (kg)	Sug. Air Comp. (HP)
		inch	mm		ft-lb	N.m.	inch	mm			scfm	l/min	lb	kg	psi	kg/cm ²		
AT-5052	3/8"	3/8	10	160	50	6.9	10.24	260	1/4"	3/8"	10	283	2.60	1.18	90	6.3	20/Ctn/24.2 kg /0.9'	2
AT-5056	3/8"	3/8	10	160	60	81	10.43	265	1/4"	3/8"	9.5	241	2.60	1.18	90	6.3	20/Ctn/27.0 kg /1.05'	2
AT-5153	3/8"	1/4	6	270	20	27	8.07	205	1/4"	1/4"	8	226	1.45	0.66	90	6.3	30/Ctn/22.8 kg /0.84'	2
AT-5158	3/8"	1/2	12	270	80	108	12.40	315	1/4"	3/8"	12	340	3.44	1.56	90	6.3	12/Ctn/20.5 kg /0.61'	3
AT-5251	3/8"	1/4	6	260	15	20	5.12	130	1/4"	1/4"	5	142	0.99	0.45	90	6.3	20/Ctn/11 kg /0.3'	2
AT-5252	3/8"	3/8	10	160	55	75	10.55	268	1/4"	3/8"	9	250	2.51	1.14	90	6.3	20/Ctn/25 kg /1.2'	2
AT-5257	3/8"	1/4	6	260	20	27	6.30	160	1/4"	1/4"	6	170	1.10	0.50	90	6.3	20/Ctn/12 kg /0.3'	2
AT-5350	3/8"	3/8	10	400	50	68	11.61	295	1/4"	3/8"	9	250	2.78	1.26	90	6.3	20/Ctn/29.0 kg /1.3'	2
AT-5352	3/8"	1/2	12	500	120	163	13.58	345	1/4"	3/8"	11	311	3.88	1.76	90	6.3	10/Ctn/24.3 kg /1.05'	3

1/4" AIR RATCHET WRENCH & KIT

AT-5152
1/4" Air ratchet wrench



AT-5256
1/4" Air ratchet wrench



AT-5250
1/4" Air ratchet wrench



AT-5055
1/4" Air ratchet wrench



AT-5001
17 pcs 3/8" Air ratchet wrench kit
AT-5002
17 pcs 1/2" Air ratchet wrench kit



AT-5056K
17 pcs 3/8" Air ratchet wrench kit
AT-5057K
17 pcs 1/2" Air ratchet wrench kit



Model No.	Square Drive	Capacity Bolt Size		Free Speed RPM	Max. Torque		Overall Length		Air Inlet (PT)	Air Hose (ID)	Avg. Air Consumption		Net Weight		Working Air Pressure		Packing Pcs/Ctn/G.W./Cuft (kg)	Sug. Air Comp. (HP)
		inch	mm		ft-lb	N.m.	inch	mm			scfm	l/min	lb	kg	psi	kg/cm ²		
AT-5055	1/4"	1/4	6	250	15	2.1	7.09	180	1/4"	1/4"	8	226	1.10	0.50	90	6.3	30/Ctn/22.0 kg /0.7'	2
AT-5152	1/4"	1/4	6	270	20	27	8.07	205	1/4"	1/4"	8	226	1.45	0.66	90	6.3	30/Ctn/22.8 kg /0.84'	2
AT-5250	1/4"	1/4	6	260	15	20	5.12	130	1/4"	1/4"	5	142	0.99	0.45	90	6.3	20/Ctn/11 kg /0.3'	2
AT-5256	1/4"	1/4	6	260	20	27	6.30	160	1/4"	1/4"	6	170	1.10	0.50	90	6.3	20/Ctn/12 kg /0.3'	2

Model No.	AT-5001	AT-5002	AT-5056K	AT-5057K
Contents	1 Pc AT-5052 air ratchet wrench 7 Pcs impact socket : 10,11,12,13,14,17,19 mm 1 Pc 3"L extension bar 1 Pc 3"L bit extension bar 1 Pc U-joint 1 Pc oil pot 3 Pcs bit 1 Pc male coupler 1 Pc blow case Packing : 5 Set/Ctn/13 kg/0.84'	1 Pc AT-5053 air ratchet wrench 7 Pcs impact socket : 10,11,12,13,14,17,19 mm 1 Pc 3"L extension bar 1 Pc 3"L bit extension bar 1 Pc U-joint 1 Pc oil pot 3 Pcs bit 1 Pc male coupler 1 Pc blow case Packing : 5 Set/Ctn/13 kg/0.84'	1 Pc AT-5056 air ratchet wrench 7 Pcs impact socket : 10,11,12,13,14,17,19 mm 1 Pc 3"L extension bar 1 Pc 3"L bit extension bar 1 Pc U-joint 1 Pc oil pot 3 Pcs bit 1 Pc male coupler 1 Pc blow case Packing : 5 Set/Ctn/13 kg/0.84'	1 Pc AT-5057 air ratchet wrench 7 Pcs impact socket : 10,11,12,13,14,17,19 mm 1 Pc 3"L extension bar 1 Pc 3"L bit extension bar 1 Pc U-joint 1 Pc oil pot 3 Pcs bit 1 Pc male coupler 1 Pc blow case Packing : 5 Set/Ctn/13 kg/0.84'

AUTO SHUT-OFF OPEN-END WRENCH

One Step Operation

- Press (1) and (2) together for operation
- Press (2) for releasing the bear socket back to the position

Easy Torque Adjustment

External torque adjustment design allow end-user to “roughly adjust” the tools to the desired torque.



Partial through & through type of gear sockets are available upon request for more application requirements. Gear with lip to prevent disengagement from the nut. Small head design offers better access to hard-to-reach work spaces.

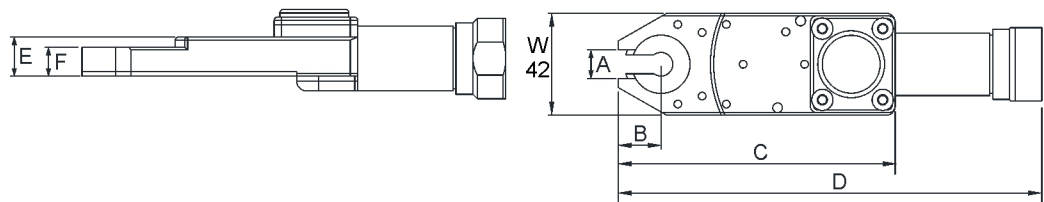

Non-reversible Type

Model No.	Free Speed	Torque Range		Socket Size	Net Weight		Air Inlet (PT)	Air Hose (ID) mm	Head Size					
		ft-lb	N.m.		lb	kg			A	B	C	D	E	F
AT-5210NA	230	2.2~5.9	3~8	6,8,9,10,11,12	4.4	2.0	1/4"	8	12	17.3	112.9	172.6	16	10
AT-5210NB	230	3.7~12.5	5~17	6,8,9,10,11,12	4.4	2.0	1/4"	8	12	17.3	112.9	172.6	16	10
AT-5211NA	230	3.7~12.5	5~17	13,14	4.8	2.2	1/4"	8	19	17	123.2	177	16	12
AT-5211NB	170	5.2~17.7	7~24	15,17,19,21,22	4.8	2.2	1/4"	8	19	17	123.2	177	16	12

Fastening & Reversing Type

Model No.	Free Speed	Torque Range		Socket Size	Net Weight		Air Inlet (PT)	Air Hose (ID) mm	Head Size					
		ft-lb	N.m.		lb	kg			A	B	C	D	E	F
AT-5210RA	230	2.2~5.9	3~8	6,8,9,10,11,12	4.4	2.0	1/4"	8	12	17.3	112.9	172.6	16	10
AT-5210RB	230	3.7~12.5	5~17	6,8,9,10,11,12	4.4	2.0	1/4"	8	12	17.3	112.9	172.6	16	10
AT-5211RA	230	3.7~12.5	5~17	13,14	4.8	2.2	1/4"	8	19	17	123.2	177	16	12
AT-5211RB	170	5.2~17.7	7~24	15,17,19,21,22	4.8	2.2	1/4"	8	19	17	123.2	177	16	12

AIR RATCHET BOX WRENCH

AT-5110-06 6mm
AT-5110-07 7mm
AT-5110-08 8mm
AT-5110-09 9mm
AT-5110-10 10mm
AT-5110-11 11mm
AT-5110-12 12mm



AT-5111-10 10mm
AT-5111-11 11mm
AT-5111-12 12mm
AT-5111-13 13mm
AT-5111-14 14mm



AT-5112-15 15mm
AT-5112-16 16mm
AT-5112-17 17mm
AT-5112-18 18mm
AT-5112-19 19mm



AT-5113-21 21mm
AT-5113-22 22mm
AT-5113-23 23mm
AT-5113-24 24mm
AT-5113-26 26mm
AT-5113-27 27mm

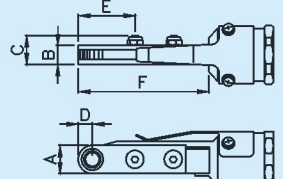

Head Size 	Model No.	A		B		C		D		E		F	
		mm	inch	mm	inch	mm	inch	mm	inch	mm	inch	mm	inch
	AT-5110		20	0.79	13.2	0.52	20	0.79	10.2	0.40	38.2	1.50	88.2
AT-5111		25.2	0.99	18	0.71	26	1.02	12.2	0.48	44.4	1.75	109	4.29
AT-5112		33.2	1.31	18	0.71	26	1.02	16.6	0.65	51	2.01	115	4.53
AT-5113		41	1.61	18	0.71	26	1.02	20.5	0.81	59	2.32	123	4.84

FEATURES :

- The ratchet wrench can be used in narrow working spaces and can fasten bolts and nuts easily. This special tool can be reached tight place that other air tools can not.
- Remove: loosen nut by wrench then take nut out with air ratchet.
- Fasten: Push trigger to polisher the nut then lock it with torque wrench.

SPECIFICATIONS (at 90psi-6.2bar)

Model No.	Hex. Box size mm	Free Speed RPM	Max. Torque		Overall Length		Air Inlet (PT)	Air Hose (ID)	Avg. Air Consumption		Net Weight	
			ft-lb	N.m.	inch	mm			scfm	l/min	lb	kg
AT-5110	6, 7, 8, 9, 10, 11, 12	180	10	13.6	11.02	280	1/4"	3/8"	6	170	2.82	1.28
AT-5111	10, 11, 12, 13, 14	200	18	25	13.39	340	1/4"	3/8"	8	226	4.21	1.91
AT-5112	15, 16, 17, 18, 19	150	60	81	15.35	390	1/4"	3/8"	12	340	5.33	2.42
AT-5113	21, 22, 23, 24, 26, 27	130	66	90	15.66	398	1/4"	3/8"	12	340	5.46	2.48